

Rear Seat Replacement

Disassemble in the numbered sequence.

NOTE: Take care not to split the seams or damage the seat covers.

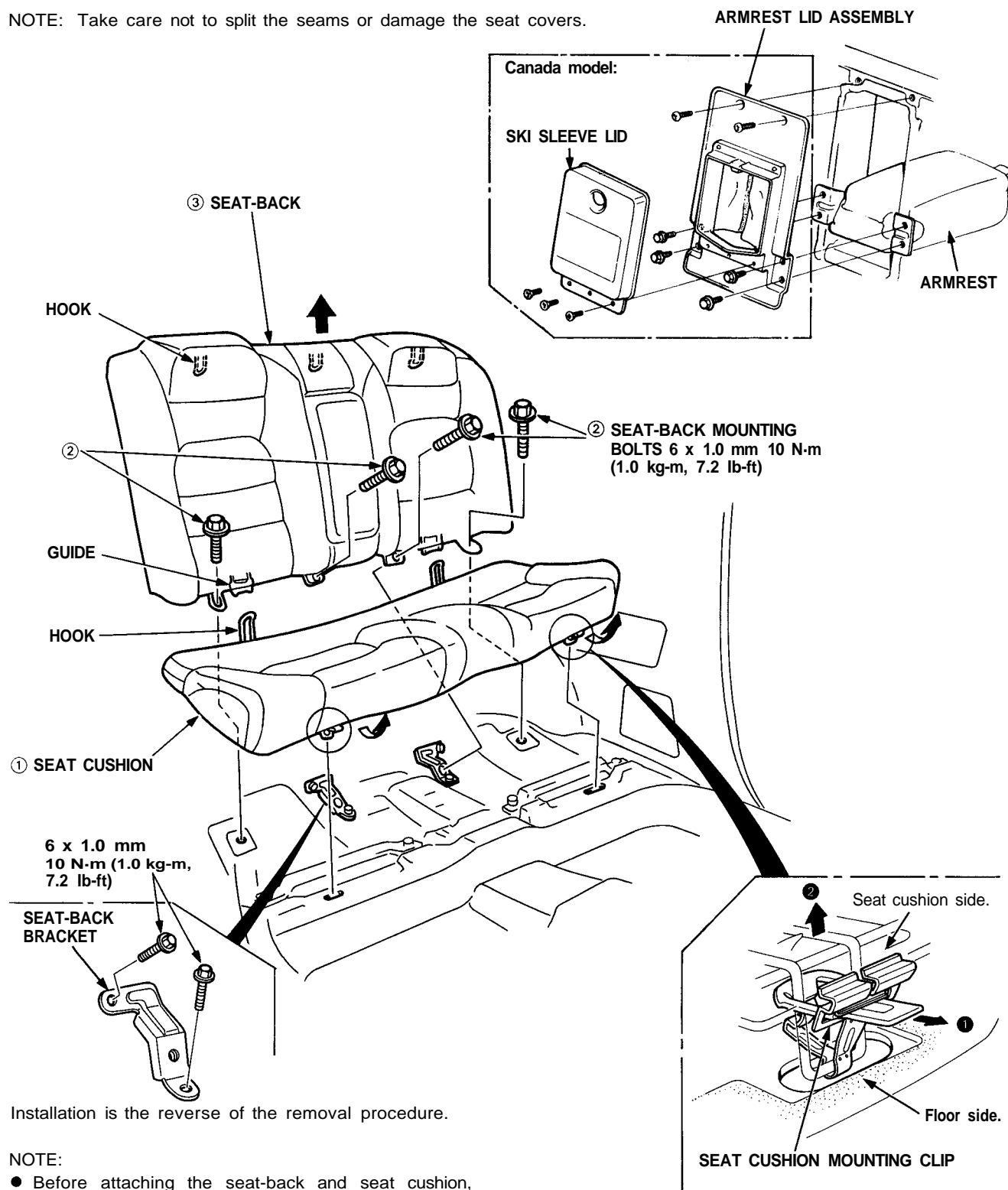

Installation is the reverse of the removal procedure.

NOTE:

- Before attaching the seat-back and seat cushion, make sure there are no twists in the rear seat belts.
- When installing the seat cushion, position the rear seat belts correctly.